

CERTIFICATE OF LOCATION OF GOVERNMENT CORNER

North Quarter Corner of Section 30, Township 108, Range 43, 5th P.M.

STATE OF MINNESOTA, County of Murray

At the corner location shown on the sketch:

- On 10-10-01 found a large flat top stone.
DATE
- left monument as found, lowered monument, removed monument (explain)
- On 10-10-01 placed a rerod w/seal #11943 on the north side of the stone.
DATE Set a pipe at the road surface.

SKETCH OF REFERENCE TIES

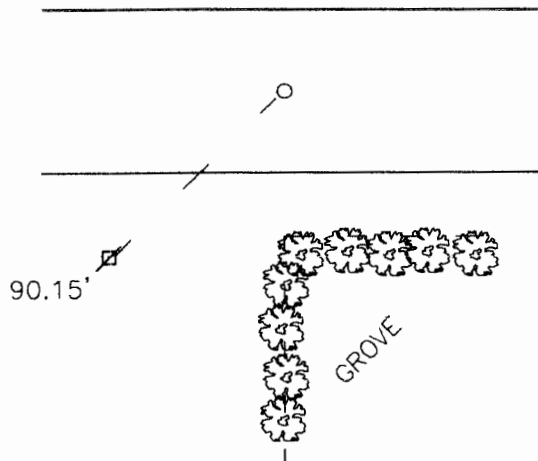

Nail and seal in power pole Southwest 90.15 feet.

Statement of evidence relative to this corner location is on back of page.

I hereby certify that this document and the data contained herein was prepared by me or under my direct supervision.

Lyle C. Moseng 2-12-04
SIGNATURE DATE

Registration No. 11943
 Land Surveyor, Professional Engineer
 County Surveyor, County Engineer

OFFICE OF THE COUNTY RECORDER

County of _____

I hereby certify that this document was filed in the Co. Recorders office at _____ .M on the _____ day of 6-18-04 A.D. 19__

County Recorder James V. Johnson
 By _____, Deputy

DOCUMENT NO. _____

Statement of Evidence

On October 10, 2001 Moseng Land Surveying and Clyde Krog dug with a backhoe and found a large flat top stone. We set a rerod with a seal on the north side of the stone. We then set a iron pipe at the road surface.